

Reliant Inserter Feeder

Overview

Streamfeeder's Reliant Inserter Feeder is designed for 6x9 swing-arm inserters. It combines flexible performance and variable speed with superior feeding capabilities. Precisely separate, singulate, and present many types of mail inserts to the gripper jaw of swing arm inserters.

This feeder can also run continuously on inkjet and tabber bases by simply repositioning the sensor out of the product path.

Standard Features

- Digital Speed Indicator
- Long-lasting natural gum rubber feed belts
- Independent side guide positioning
- Self-adjusting discharge hold down
- Patented product separator
- High-performance photo sensor, tool-less adjust
- Suction cup mounting to the rear inserter table
- Material control keep products in position at jaw
- Small product insert plate

Applications

- 6x9 Swing-arm Inserters
- Inkjet Systems
- Laminators
- Tabbers

Products

- Brochures
- Business Cards
- Cardstock
- C-Folds
- Envelopes
- Manuals
- Payment Booklets
- Plastic Cards
- Post Cards
- Sheet Paper
- Z-Folds

Contact our experienced sales team today for a comprehensive review of your application/product and see how our Reliant Inserter Feeder can benefit your company.

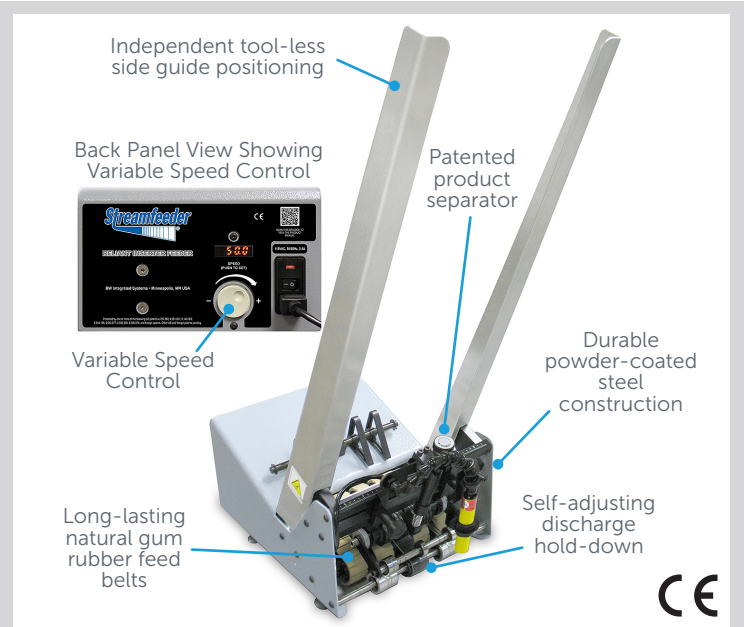

Specifications	
Maximum Product Size	9.25" wide x 6" long (235 x 152 mm)
Minimum Product Size	2.125" wide x 2.25" long (54 x 57 mm)
Min/Max Product thickness	.003" - .250" (.076 - 6.35 mm)
Belt Speed	1,330 in/min (33,782 mm/min)
Utilities	115/230vac, 50/60Hz, 2.5A
Weight	19 lbs. (8.62 kg)
Warranty	Two year limited
Other sizes and thickness capabilities available.	

AMBEC | CBI | Fleetwood | Goldco | Nigrelli | Streamfeeder | SWF | Thiele | Tisma

